



CONNECT FCU

CONNECT FCU VALVE PACKAGE, PN25

Model Number: ML-CFCUT

FEATURES / CHARACTERISTICS

Pre-assembled, tested and ready for installation
 2-Union 3-Way By-Pass Assembly, PN25 Rated.
 By-Pass Include Two 3-Way Isolating Ball Valves
 Inbuilt Y-Strainer with Drain
 By-Pass Unit with Pressure Independent Control
 Valve with different Actuators (On-Off/Floating/
 Modulating types)
 Insulated Stainless Steel Braided Flexibles Hoses for
 Supply and return connection 300mm (Standard)
 length & EPP Insulation cover



HYDROSTATIC TEST PRESSURE WORKING TEMPERATURE

Shell- 37.5 bar

-10° to 110° C water

Seat- 27.5 bar

ON REQUEST

Flexible Hoses with varying lengths(200mm~300mm) Flexible Hoses with Brass/DZR Brass end connection, Fire Rated Insulation Box (All options subject to minimum order quantities)

DIMENSIONS (mm)

DN		A	B	C	D	E	L	H	Model No.
mm	inches								
15	½"	80	143	150	150	76	228	158	ML-CFCUT-15-A/AB
20	¾"	80	139	154	154	78	228	158	ML-CFCUT-20-A/AB
25	1"	80	156	172	172	87	228	158	ML-CFCUT-25-A/AB

*All dimensions are nominal (indicative)
 Actual dimensions may vary

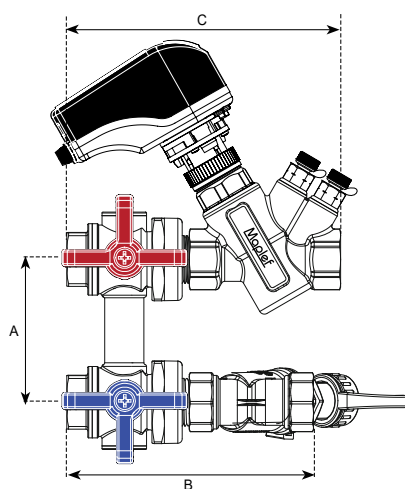

Maple Connect FCU ML-CFCUT - top view

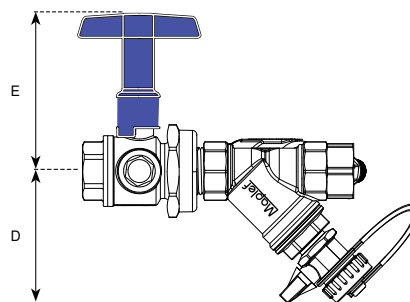

Maple Connect FCU ML-CFCUT - side view

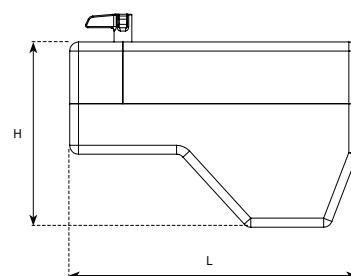

EPP Insulation Assembly



CONNECT FCU

CONNECT FCU VALVE PACKAGE, PN25

Model Number: ML-CFCUT

MATERIAL SPECIFICATIONS

SR.	PARTS	MATERIAL
1	By Pass Unit Body	DZR Brass
2	PICV Body	DZR Brass
3	By-Pass Ball Valves	Nickel-plated brass
4	By-Pass Handles, Extended	Aluminum
5	Strainer Mesh	Stainless Steel
6	Drain Valve	DZR Brass
7	Drain Ball Valve	Nickel-plated brass
8	Drain Valve Handle	Aluminum
9	Insulation	EPP
10	Flexible Hoses	Insulated Stainless Steel



*For technical related details of Pressure Independent Control Valves & Actuators, Please refer to Maple PICV Technotes.

*For technical related details of Flexible Hoses(300mm Length), Please refer to Maple Flexible Connector Technotes