



BALL VALVE

STAINLESS STEEL TWO PIECE, 1000 WOG

Model Number: MV10-11234

FEATURES / CHARACTERISTICS

Working Pressure	1000 WOG
Design	ASME B16.34
Connections	ASME B1.20.1
Temp & Pressure	Thread Ends ASME B16.34
Working Medium	Water, Oil and Steam

Two Piece Body, Full Bore, PTFE Seats and Stem Seals

ON REQUEST

BS EN Threads, (subject to minimum order quantities)

HYDROSTATIC TEST PRESSURE

Shell- 24 bar
Seat- 17.6 bar

WORKING TEMPERATURE

-29°C~120°C water

MATERIAL SPECIFICATIONS

	PARTS	MATERIAL
1	Body	A351 CF8M
2	Stem	A182 F316
3	Ball	SS316
4	Seat	PTFE
5	Thrust Washer	PTFE
6	Packing	PTFE
7	Nut	A2-70
8	Handle	SS201+PVC

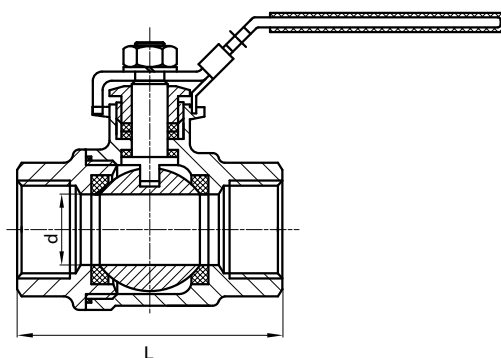

DIMENSIONS (mm)

Sizes		L	d
DN	inch		
10	1/4"	52	9
15	1/2"	56	15
20	3/4"	63	20
25	1"	71	25
32	1 1/4"	82	32
40	1 1/2"	94	40
50	2"	108	50
65	2 1/2"	144	65
80	3"	168	80

*All dimensions are nominal (indicative)
Actual dimensions may vary