



# THERMOSTATIC MIXING VALVE

**DZR BRASS THERMOSTATIC MIXING VALVE, 174psi**

**Model Number: MV300-1**

## FEATURES / CHARACTERISTICS

Rating 174psi (12 bar)

Connections Threaded

Working Medium Water

Minimum Flow Rate: 1 USGPM

Temperature Setting Range: 32° ~ 60°C(±2°C)



## ON REQUEST

NPT Threads, (subject to minimum order quantities)

## HYDROSTATIC TEST PRESSURE

Shell- 18 bar

## WORKING TEMPERATURE

174 psi (12 bar) 32° ~ 60°C(±2°C) water

## MATERIAL SPECIFICATIONS

	PARTS	MATERIAL
1	Body & Bonnet	DZR Brass (CW602N) nickel plated
2	Piston Assembly	Thermoplastic
3	Element	Vernet
4	Spring	Stainless Steel 304
5	O-Ring	EPDM
6	Control Knob	ABS

## DIMENSIONS (mm)

Sizes		A	B	C	D
DN	inch				
15	½"	53	57	60	G½"
20	¾"	53	57	70	G¾"
25	1"	62	66.5	80.5	G1"

\*All dimensions are nominal (indicative)  
Actual dimensions may vary

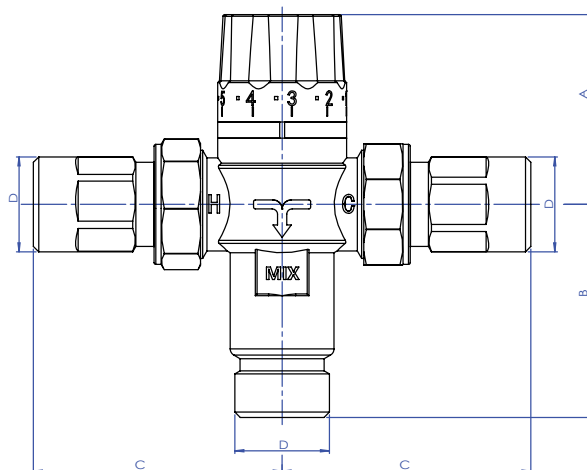

## DETAILS

Thermostatic Mixing Valve mixes hot and cold water to obtain mixed water at a stabilized temperature and shut off the hot water flow in case of failure in the cold water supply at the inlet to eliminate the risk of scalding.

The high-quality thermostatic element in the thermostatic mixing valve will control the mixing of the hot and cold supply water to provide mixed, tempered, water to connected fixtures.

This provides constant water temperature under varying-flows and temperatures.

The thermostatic mixing valves are fitted with internal strainers to protect from foreign debris entering into the valve and internal check valves to protect against the cross flow of water at a pressure differential on hot and cold water inlets.

The thermostatic mixing valves feature has setting positions including Min. & Max. for accurate control and quick set-ups.