



HOSE BIB COCK

BRASS BALL LOCKABLE BIB-COCK WITH HOSE UNION, PN16

Model Number: MV700-2.LS

FEATURES / CHARACTERISTICS

Rating	PN16
Connection	ISO228
Working Medium	Water

Nickle Plated Brass Body, Chrome Plated Brass Ball, Quarter Turn Lockable Handle, Hose Connection

ON REQUEST

NPT Threads (subject to minimum order quantities)

HYDROSTATIC TEST PRESSURE

Shell- 24 bar
Seat- 17.6 bar

WORKING TEMPERATURE

16 Bar -10° C to 110° C water

MATERIAL SPECIFICATIONS

	PARTS	MATERIAL
1	Body	Brass (Ni Plated)
2	Ball	Brass (Cr. Plated)
3	Seat	PTFE
4	Bonnet	Brass (Ni Plated)
5	Stem	Brass (Ni Plated)
6	O-Ring	NBR
7	Handle	Carbon Steel
8	Rivets	Carbon Steel (Zn Plated)
9	Washer Ring	NBR
10	Union Nut	Brass (Ni Plated)
11	Hose Pipe	Stainless Steel
12	MainFold	PP (White)

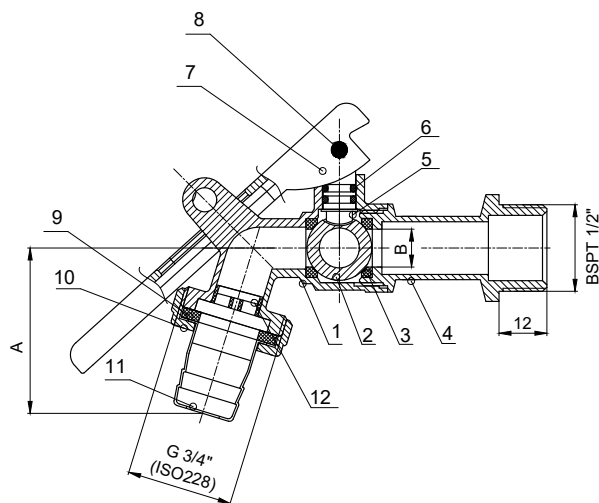

DIMENSIONS (mm)

Sizes		A	B	PN
DN1XDN2	inch			
15X20	1/2" X 3/4"	46.5	10	16

*All dimensions are nominal (indicative)
Actual dimensions may vary